

This plan document set is the sole property of Lloyd Consulting Group, LLC. No alterations to these plans, other than adding "as-built" information, are allowed by anyone other than authorized Lloyd Consulting Group, LLC employees.

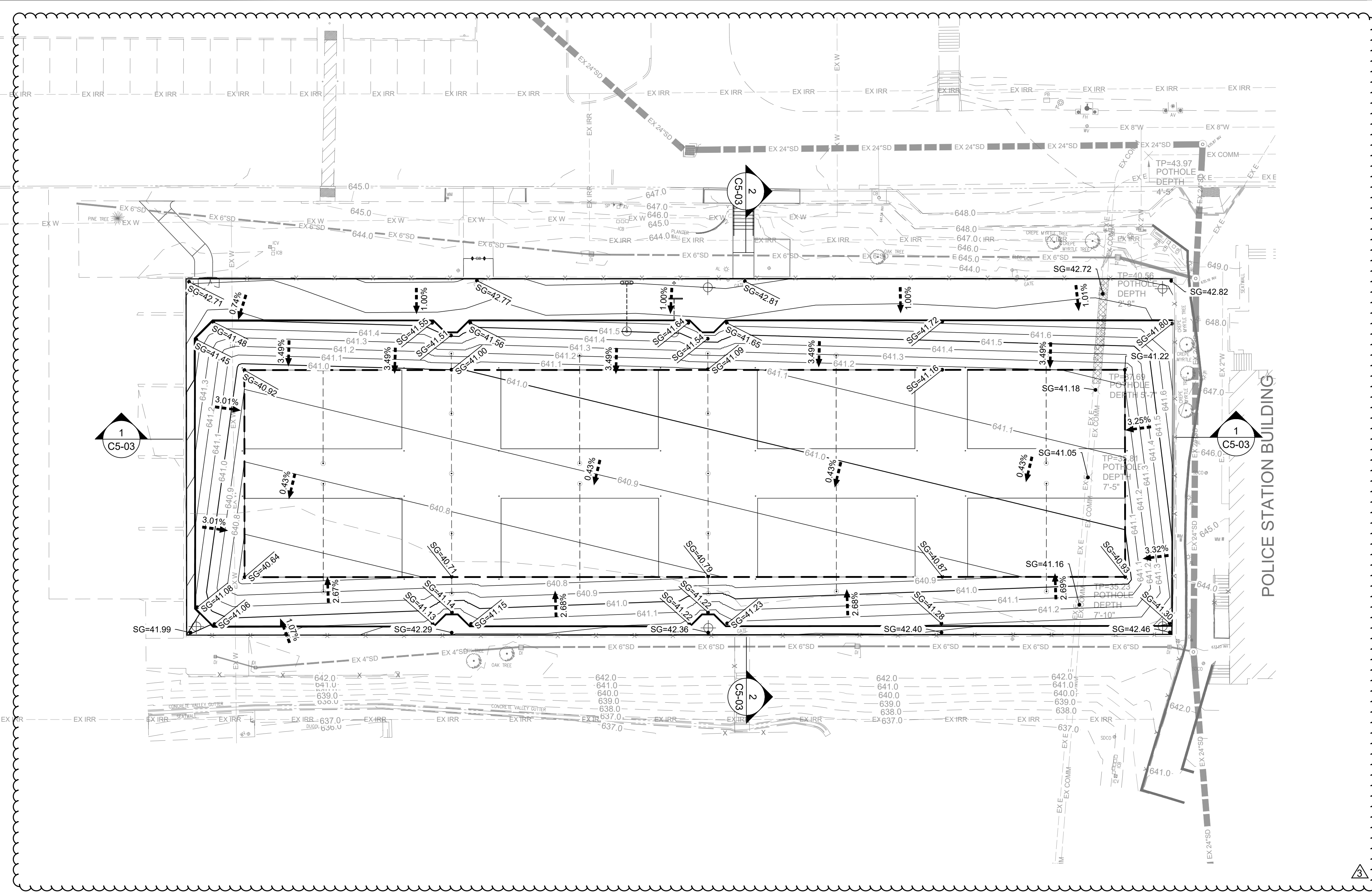

GRADING LEGEND:

- SG SUB GRADE
- 0.1' PROPOSED CONTOUR
- - - - - GRADE BREAK
- 0.51% SLOPE ARROW (PERCENT)

GRADING NOTES:

1. TOP OF SAND ELEVATIONS TO BE SET 3" BELOW ADJACENT CONCRETE SIDEWALK.
2. ELEVATIONS SHOWN ARE FINISHED GRADE, CONTRACTOR TO ACCOUNT FOR SURFACING SUCH AS LANDSCAPE FINISHING MATERIAL AND HARDSCAPE WHEN GRADING SUBGRADE.
3. EARTHWORK TO BE PERFORMED IN ACCORDANCE WITH SPECIFICATIONS AND GEOTECHNICAL REPORT.

IDENTIFICATION STAMP
 DIV. OF THE STATE ARCHITECT
 APP: 03-123023 INC:
 REVIEWED FOR
 SS FLS ACS
 DATE: 04/19/2023



7349 N. VIA PASEO DEL SUR
 SUITE 515-324
 SCOTTSDALE, ARIZONA 85258
 PH 602.635.4226

CONSTRUCTION DOCUMENTS



REV.	DESCRIPTION
3	ELEVATION LABELS

MOORPARK COLLEGE BEACH VOLLEYBALL COURTS

DESIGNED:	BL
DATE:	APR 4, 2023
DRAWN:	TML
PROJ.	21-152
SCALE:	1" = 20'

GRADING PLAN - SUBGRADE
 DWG. NO.
C5-02

